

EXISTING SITE PLAN
SCALE: 1" = 15'-0"

**PROPOSED SUBDIVISION FOR:
ENDLESS SUMMER VIEW L.L.C.**

2, 4, 6, 8 & 10 LAVALLETTE AVENUE
BLOCKS 66 & 68, LOTS 1, 29, 30, 31, 32 & 33
BOROUGH OF LAVALLETTE, OCEAN COUNTY, NEW JERSEY

MELILLO ARCHITECTURE



PH: 732.974.8593 FAX: 732.974.8594
1325 WARREN AVE., SUITE 8
SPRING LAKE HEIGHTS, NEW JERSEY 07762

REVISIONS:
1 FEBRUARY 01, 2010

DATE: OCTOBER 28, 2009
DRAWN BY: MEM

Michael Melillo
MICHAEL MELILLO, AIA
REGISTERED ARCHITECT

TS-1
SHEET 1 OF 3

Lic. No. AI 10928

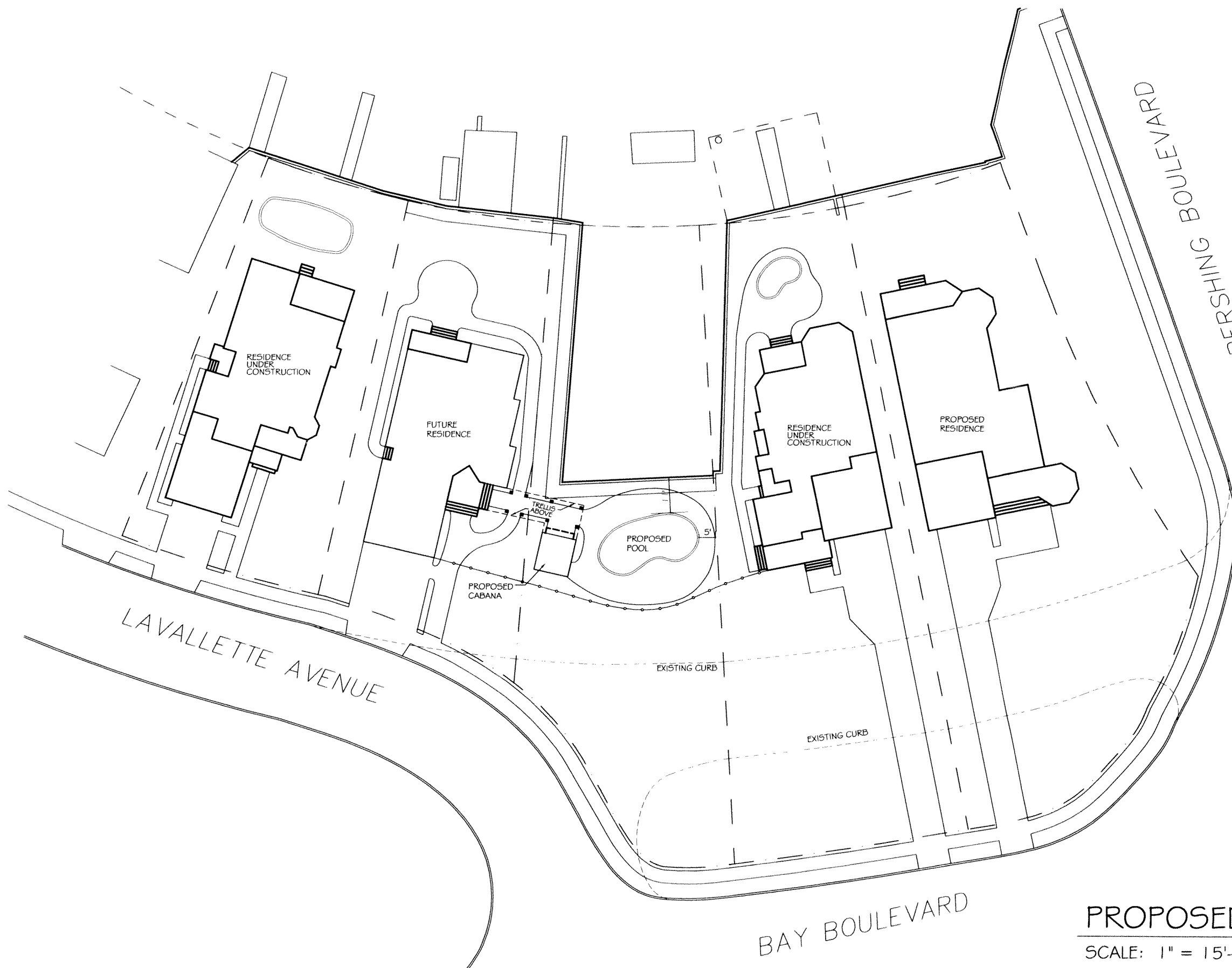

PROPOSED SITE PLAN

SCALE: 1" = 15'-0"

MICHAEL MELILLO, AIA
Michael Melillo
 NJ Lic. No. AI 10928

TS-2
 SHEET 2 OF 3

PROJECT:
**PROPOSED SUBDIVISION FOR:
 ENDLESS SUMMER VIEW L.L.C.**

2, 4, 6, 8 & 10 LAVALLETT AVENUE
 BLOCKS 66 & 68, LOTS 1, 29, 30, 31, 32 & 33
 BOROUGH OF LAVALLETT, OCEAN COUNTY, NEW JERSEY

MELILLO ARCHITECTURE



PH: 732.974.8593 FAX: 732.974.8594
 1325 W WARREN AVE, SUITE 8
 SPRING LAKE HEIGHTS, NEW JERSEY 07762

REVISIONS:
 1 FEBRUARY 01, 2010

DATE: OCTOBER 28, 2009
 DRAWN BY: MEM

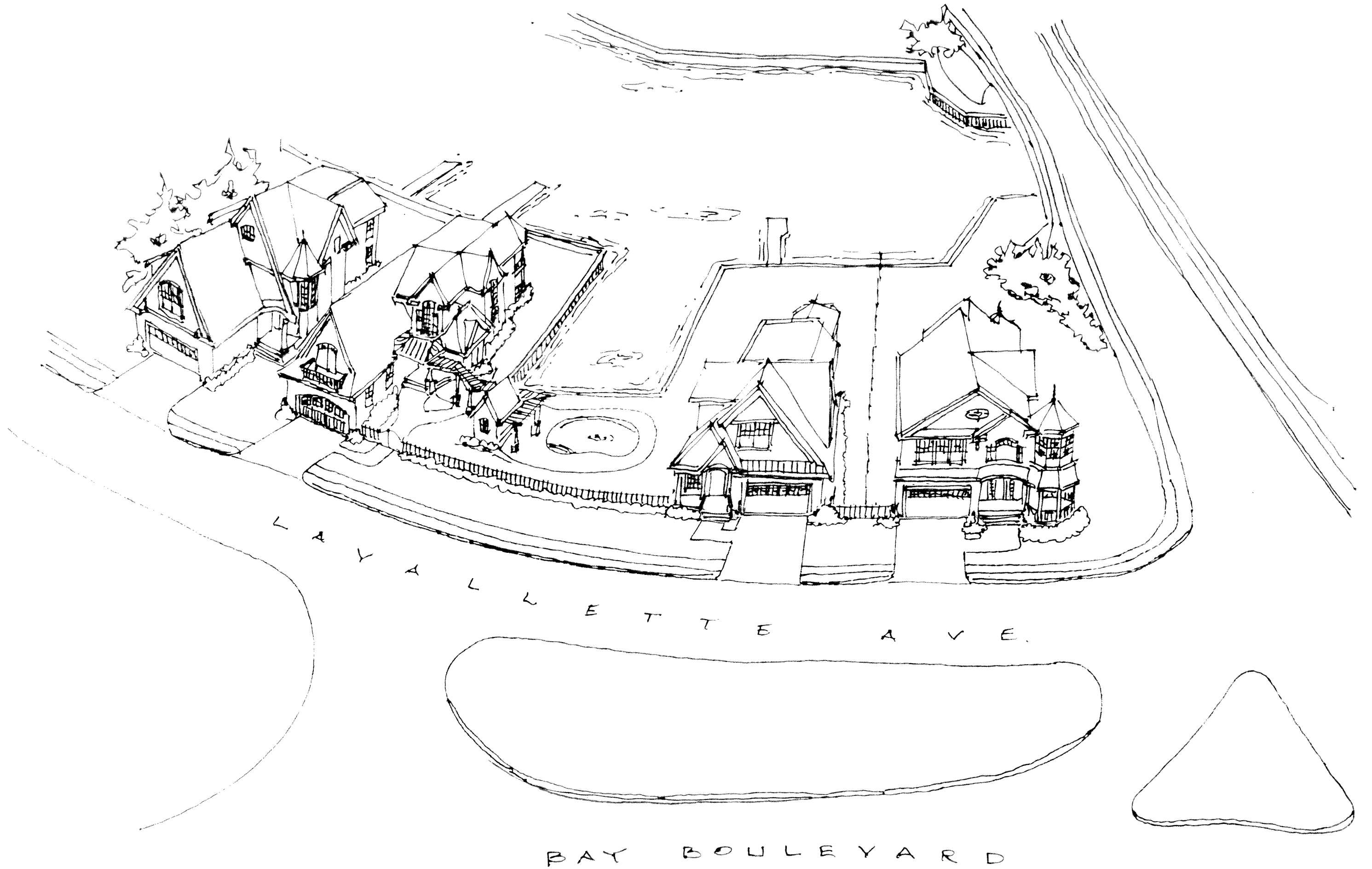

L A Y A L L E T T E A V E.

B A Y B O U L E Y A R D

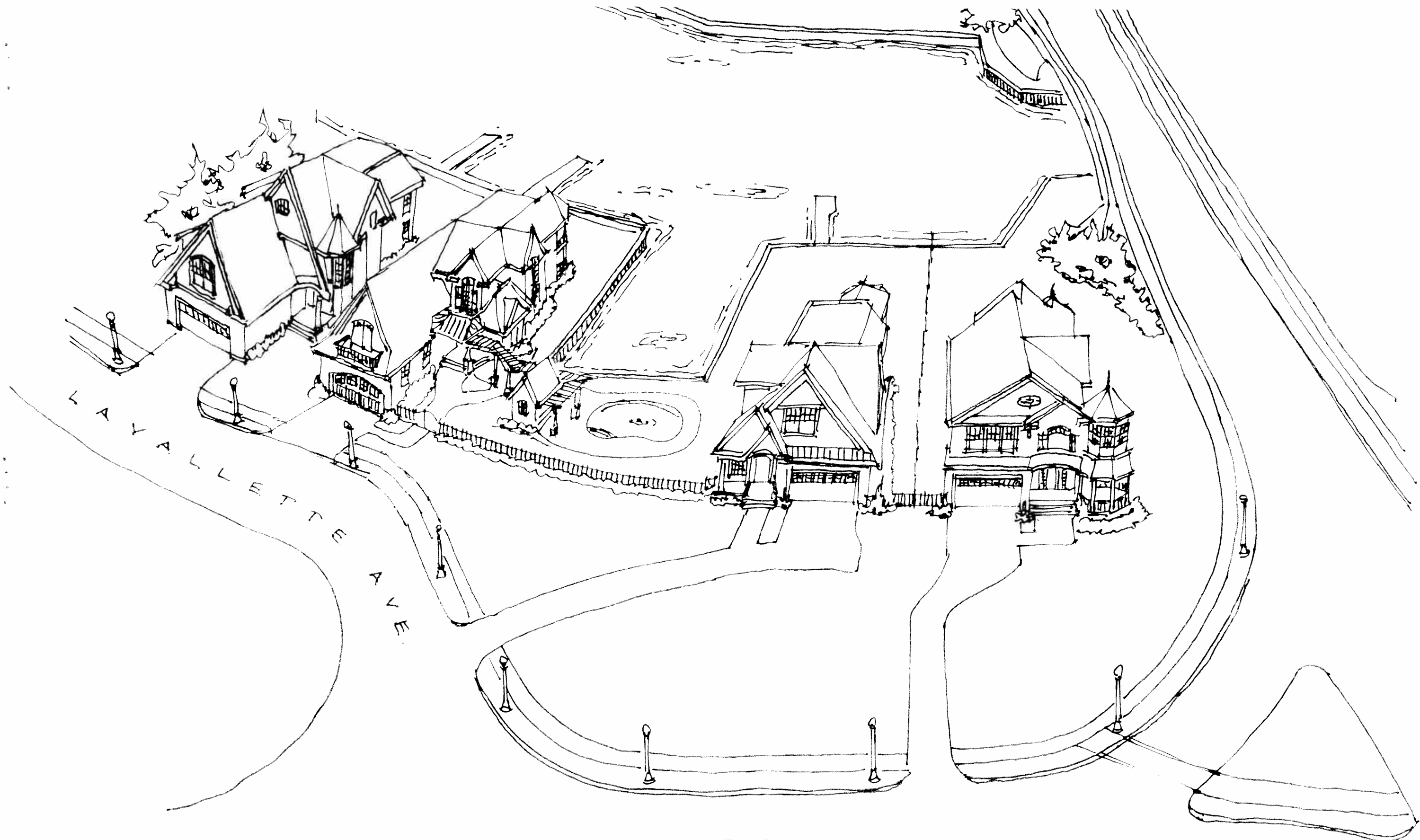

KAYALLETTE AVE

BAY BOULEYARD